

# AeroCatch<sup>®</sup> 3

## Operating and Installation

### 320 Plus Flush Series

Thank you for selecting the **AeroCatch3** shear and tension latch. The following instructions are to help you successfully install and use this unique product. The kit contains 2 **AeroCatch3** latches, 4 fixing plates, full installation and operation instructions, fasteners and panel cut-out template.

#### Operation

Before starting please familiarise yourself with the **AeroCatch3**. Depress the square shaped secondary lock button and lift handle

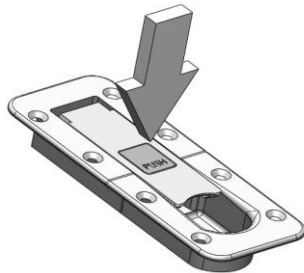

until you override the handle hold-up detent (around 110°), at this position the drawhook is clear of the strike allowing the panels to be pulled apart and the shear tongue disengaged.

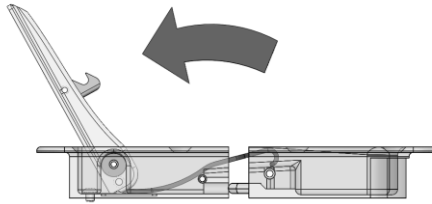

To close the latch, put the panels together and engage the shear tongue, push the handle down until the drawhook engages the strike, pulls the panels together and the secondary lock button snaps in position. An audible click can be heard as it locks.

#### Installation

Once you have unpacked your **AeroCatch3** kit you have two options for marking the panel cut-out. You can use either the cardboard packaging template provided for the panel top, or the dimensions shown on the installation drawings enclosed.

First clamp the two panels together in the required position.

Lay the cardboard packaging sheet out flat, you will see two sets of cross lines on the template, these determine the centre line of the latch and the panel split line.

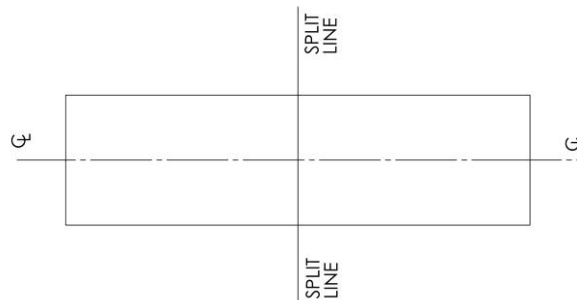

Check that there is sufficient room below the panel for the housings and the location is either flat or with minimal radius. Place the template onto the panel. Using a straight edge line up the split lines on the template with the panel split line. Mark around the cut-out and remove the template.

Remove the clamps holding the panels together and mark the cut-out on the return face of both panels. You can now cut the panels as required.

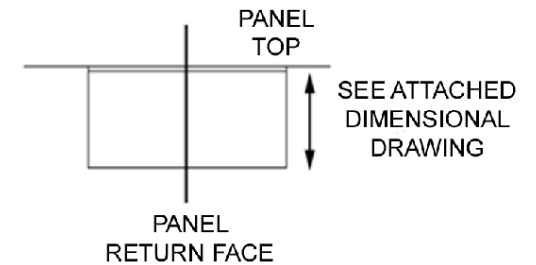

To install the 320 Plus Flush Series place the **AeroCatch3** in position and mark the fixing holes, (remember the **AeroCatch3** is symmetrical so you can fit the latch or the strike either side). Alternatively use the dimensions on the installation drawings using the position of the panel split and centre lines as datum points. Drill the fixing holes. Place one half of the **AeroCatch3** in position and fasten using the countersunk bolts and load plate provided. The load plate has a return on it that will sit behind the return face of the panel; the gap between the two should be filled with a suitable filler to improve the tensile load carrying capability. Repeat the procedure for the other half.

**AeroCatch3 320 Plus Flush Series**  
installation

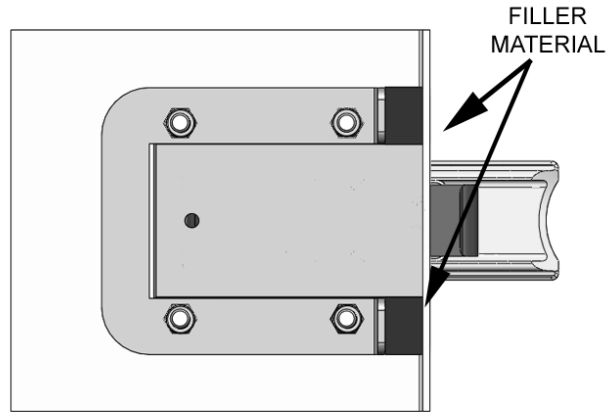
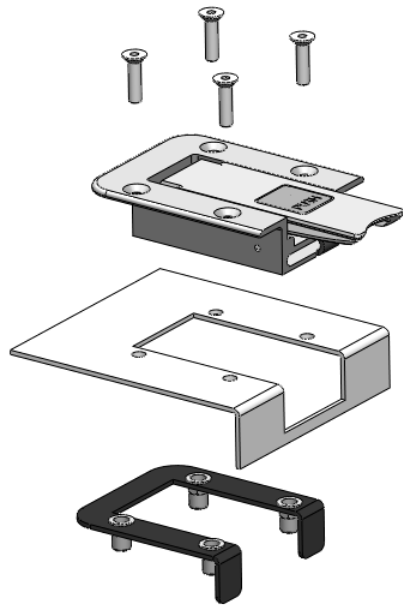

View from below

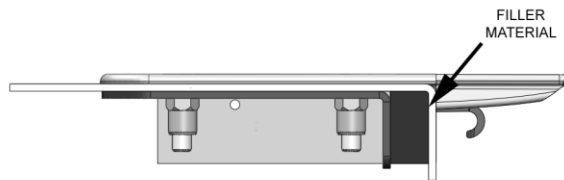
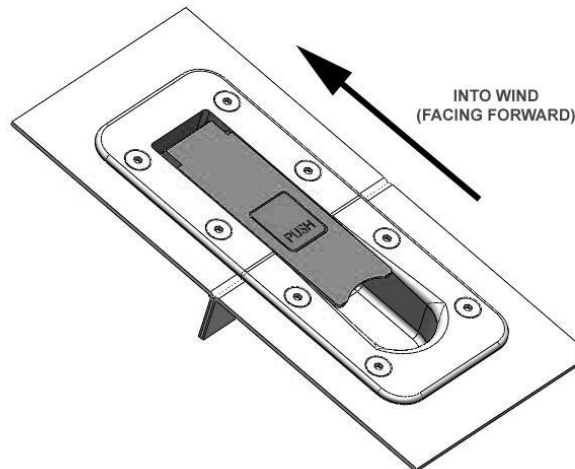

View from side

**Care of your AeroCatch3**

To optimise performance of your **AeroCatch3**, clean mechanism regularly with a small brush and lubricate with a light spray oil wiping away any excess

**Technical Support**

We hope these instructions will enable you to successfully install and use **AeroCatch3**. Should you encounter problems or wish to use it in a different application area please call our technical support on +44 (0)1803 868677, FAX on +44(0)1803 86878, email us at [graham@aerocatch.com](mailto:graham@aerocatch.com) or visit our website at [www.AeroCatch.com](http://www.AeroCatch.com)