

Classic 250

Classic 250 “Monza” Fuel Filler Cap.

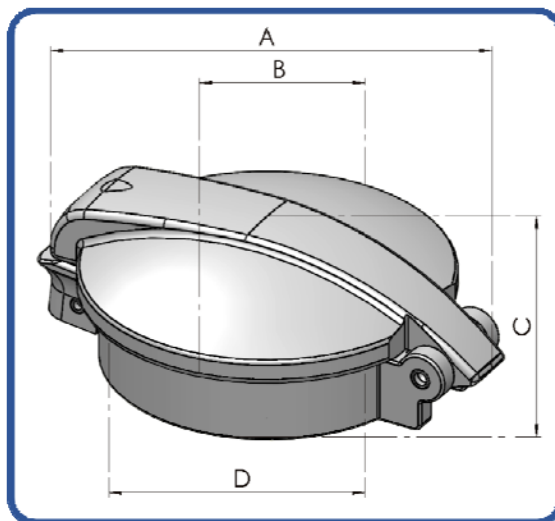

Specifications:

Options:

Fixing Arrangement:

Applications:

Compatibilities:

Finish:

Weight:

Supplied With:

N/A

2.5" x 16TPI WHIT FORM Thread

Fuel, Oil & Water Tanks

Compatible with Add Blue

Operation Temperature -40°C to +80°C

Natural Polished

126.0 grams

Fibre Gasket

Materials:

Centre Cap:

Flange:

O-Ring:

Seal Plate:

Gasket:

Aluminium Alloy LM25 Cast

Aluminium Alloy LM25 Cast

Viton A (FPM or FKM)

Brass

Fibre Vulcan

Dimensions:

Length A:

Width B:

Height C:

Thread D:

Bore Diameter:

100.0mm

76.0mm

32.0mm

2.5" x 16TPI WHIT FORM Thread

53.0

Optional('s):

Flange

Flange Neck